

## Technical Data

Sample Material:	Serum, Plasma (depending on test: Lithium-Heparin-, EDTA- or Citrat-Plasma)
Measurement:	Absorption Photometry
Interface:	RS-232, USB
Results:	Display, optional print-out
Display:	LCD Touchscreen Display
Data Memory:	up to 250 measurement results
Dimension:	26 x 14,5 x 14 cm (H x W x D)
Weight:	ca. 3,5 kg



## EUROlyser solo

Specialist in  
Point-of-Care Diagnostic!

**+++ NEW +++  
canines Progesterone,  
Bile Acids,  
Lactate**



scil animal care company GmbH  
Dina-Weissmann-Allee 6  
68519 Viernheim  
Germany  
Tel.: +49 (0) 6204 78 90 0  
Fax: +49 (0) 6204 78 90 200  
Email: [info-de@scilvet.com](mailto:info-de@scilvet.com)  
[www.scilvet.com](http://www.scilvet.com)

Vers. ENG20180801

# Specialist in Point-of-Care Diagnostic!

Complete your clinical chemical profile with the veterinary analyzer EUROlyser solo to determine the parameters T4, Fructosamine, Lipase (pancreas-specific), Ammonia, cCRP, SAA, Fibrinogen, GLDH, Phenobarbital, Bile Acids, Lactate and canine Progesterone.

The EUROlyser solo measures the parameters in a single test method. All tests are based on a wet chemistry test principle.

This smart analyzer provides for easy handling with a compact design.



## Important Additional Parameters for Daily Use!

Thyroxine (T4) • Fruktosamine • Lipase (pancreas-specific) • Ammonia • cCRP • SAA • Fibrinogen • GLDH • Phenobarbital • Lactate • Bile Acids • Progesterone



### Thyroxine (T4)

- » parameter for detection of thyroid disorders
- » for all species



### Fructosamine

- » parameter for detection and monitoring of Diabetes Mellitus
- » for all species



### Lipase (pancreas-specific)

- » parameter for detection and monitoring of pancreatitis
- » for dogs and cats



### cCRP

- » parameter for detection and monitoring of systematic inflammation
- » for dogs



### SAA

- » parameter for detection and monitoring of systematic inflammation
- » for cats and horses



### Fibrinogen

- » parameter for detection and monitoring of systematic inflammation
- » for horses



### Ammonia (NH3)

- » parameter for liver monitoring
- » for dogs



### GLDH

- » parameter for detection of liver disorders
- » for all species



### Bile Acids

- » parameter for liver monitoring
- » for all species



### canine Progesterone

- » parameter for detection of the time of mating
- » for female dogs



### Lactate

- » parameter for detection of tissue oxygenation (sepsis, shock, hypoxia)
- » for all species



### Phenobarbital

- » parameter for monitoring of Phenobarbital treatment
- » for dogs, cats and horses

## Easy Handling with just three Steps!

Run a measurement on the EUROlyser solo easily and quickly due to a modern LCD touchscreen display. All test information, batch and calibration data come up automatically with a RFID card. The intuitive menu navigation allows measurements within minutes. The measurement results can be printed via optional printer or directly transferred to the practice management software.

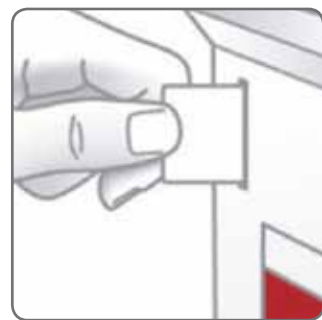

### Step 1:

Insert RFID card.

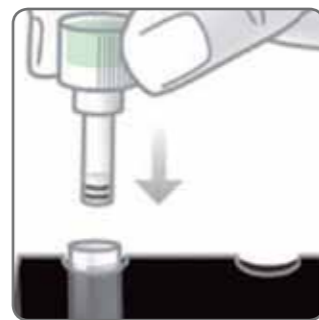

### Step 2:

Pipette sample volume and close ERS cap [EUROlyser Reagent System].

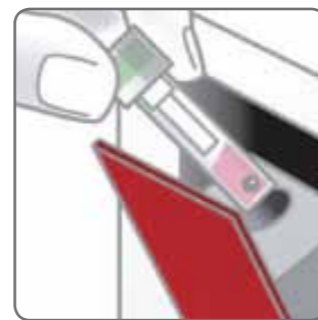

### Step 3:

Insert test cuvette.

